

1506/39 Coventry Street SOUTHBANK VIC

2  2  1 

Located in the popular Guilfoyle apartment building in Southbank, this fantastic light filled two bedroom apartment is perfectly situated to all Melbourne has to offer.

View : <https://www.briggsshaw.com.au/sale/vic/inner-city/southbank/residential/apartment/7417526>

Features include:

- Stunning city and bay views from bedrooms and living areas.
- Spacious kitchen with quality Bosh stainless steel gas appliances and integrated dishwasher
- Master bedroom with ensuite and balcony
- Built in robes to both bedrooms
- Main second bathroom
- European laundry
- Split system heating and cooling
- Intercom
- Secure garage parking

1506/39 Coventry Street, Southbank

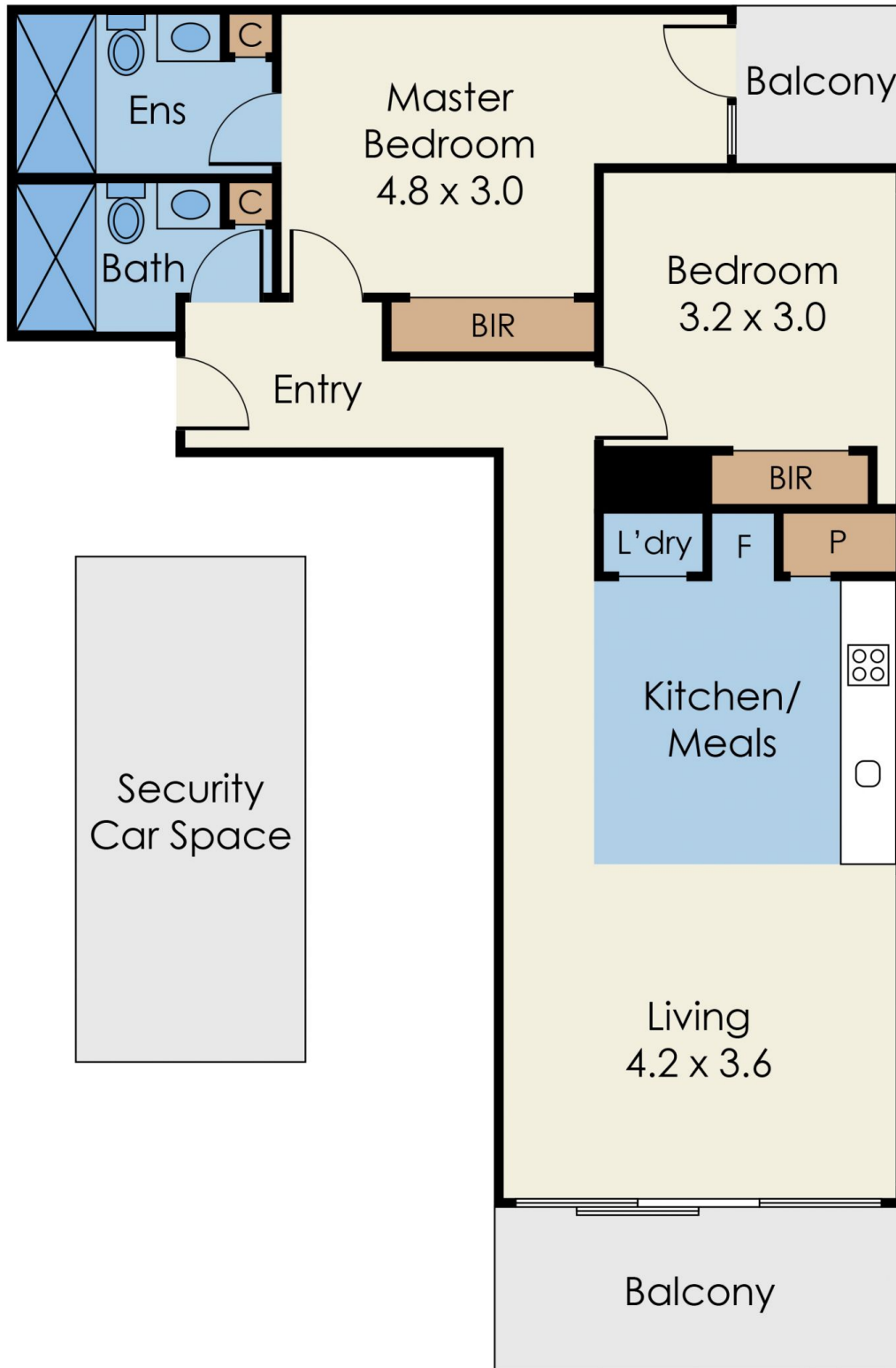

Not to Scale

Every care has been taken to verify the accuracy of details in this brochure. Prospective purchasers are requested to take such action as is necessary to satisfy themselves of any pertinent matters