



**2/18 Van Ness Avenue MORNINGTON VIC**

**3**  **2**  **2** 

This townhouse is centrally located to both Bentons Square and Main Street Shopping.

Completed 2 years ago this property offers a spacious living area and open plan kitchen leading out to a sun drenched outdoor decking ideal for entertainment. Timber floors and high ceilings add to the space as this sun filled home enjoys the benefit of ducted heating and cooling throughout to ensure you of comfort all year round.

Large 2 car garage with direct access to Kitchen / Living. Upstairs there are 2 large double bedrooms with a family bathroom , living area

\*

Bay Views

**Land Size** : 179 sqm  
**View** : <https://www.briggshaw.com.au/sale/vic/mornington-peninsula/mornington/residential/house/7417386>



## Units 2/18 Van Ness Avenue, Mornington



FIRST FLOOR



GROUND FLOOR

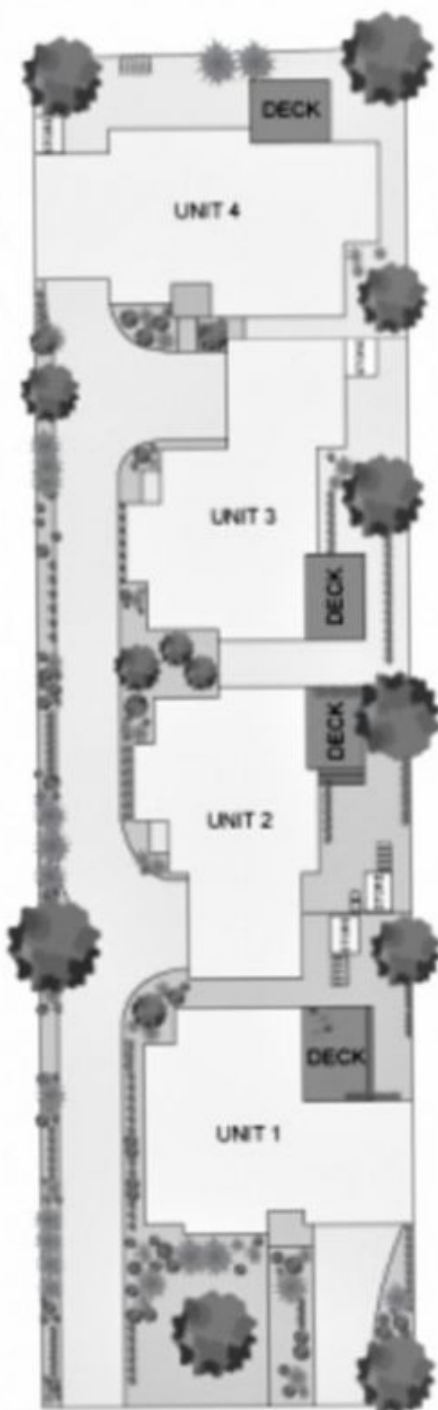

SITE PLAN

All dimensions shown are approximate and should be used as a guide only. The purchaser is the agent's client and is responsible for any errors, omissions or misstatements. This plan is illustrative only and should be used as such.