



**8 Roberts Street RYE VIC**

4  3  6 

This welcoming architectural home with dual living enjoys an abundance of natural light, large entertaining areas, coastal views and has the perfect floorplan for entertaining family and friends. As you walk through the entrance the recycled staircase guides you to the hub of this stunning home.

Comprising meticulously planned open plan family/dining room, study and a mezzanine kitchen opening to a private deck, a second large living opens to a stunning private outdoor entertaining area complete with a solar in ground pool and a custom built dog retreat. Three generous sized bedrooms, luxury master with separate bathroom and walk in robe, two further bathrooms make this a perfect permanent home or holiday/weekend destination.

Offering absolute privacy from the street the property is fully fenced with a double garage, a second secure parking

**Land Size** : 1069 sqm

**View** : <https://www.briggsshaw.com.au/sale/vic/mornington-peninsula/rye/residential/house/7417378>

Roberts Street



Site Plan

Legend

- 1 Residence
- 2 Lawn
- 3 Driveway
- 4 Vegetable Patch
- 5 Deck
- 6 Pool
- 7 Sliding Gate
- 8 Boat/Trailer Bay

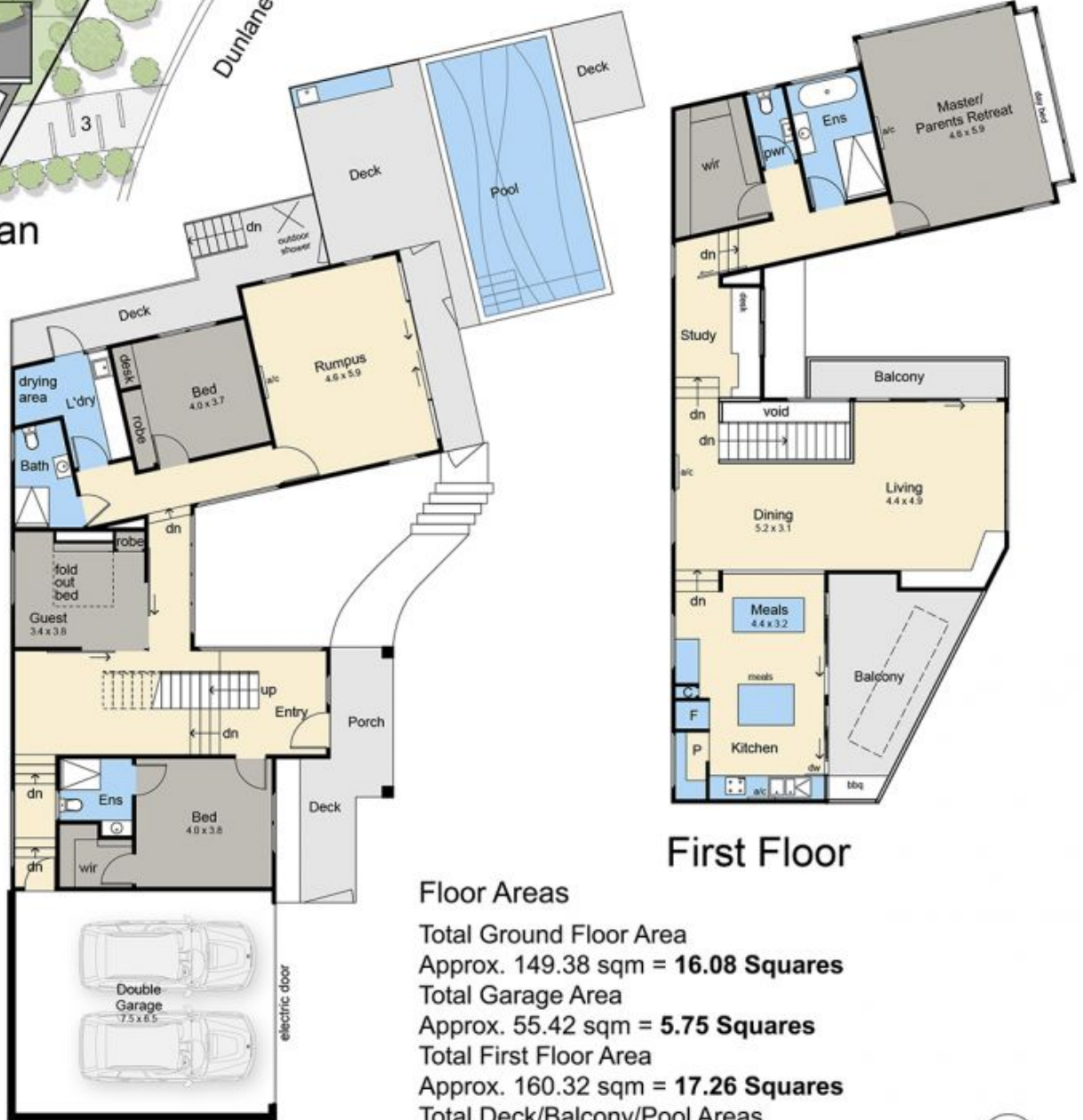

Ground Floor

First Floor

Floor Areas

- Total Ground Floor Area  
Approx. 149.38 sqm = **16.08 Squares**
- Total Garage Area  
Approx. 55.42 sqm = **5.75 Squares**
- Total First Floor Area  
Approx. 160.32 sqm = **17.26 Squares**
- Total Deck/Balcony/Pool Areas  
Approx. 57.97 sqm = **6.2 Squares**

